

www.fogelusa.com



## Deli Service Case



- White interior and exterior
- Heavy duty gravity fin coil with expansion valve installed
- 2 High/low gravity evaporator for maximum
- Foamed-in-place polyurethane insulation
- Double shelf brackets for shelf rigidity
- Extra large high triple pane hermetically sealed glass display front
- 1•(44"unit), 2•(52"unit) adjustable 10" wide stainless steel mezzanine shelf
- Service side – large multi pane easy glide sliding glass doors upper section
- R-134a Refrigerant
- 2 Rows of top lighting
- 10' wire power cord and plug
- 12 AMP convenience outlet separate circuit

Model No.	Description	Size DxLxH	Voltage	Amps	HP	Cubic Feet	Est. Ship Wt
<b>52" H</b>							
5004-SC	2 Sliding/1 Swing	33.5" x 48" x 52"	115	8.0	1/3	29	421#
5006-SC	2 Sliding/2 Swing	33.5" x 72" x 52"	115	9.0	1/2	44	740#
5008-SC	2 Sliding/2 Swing	33.5" x 96" x 52"	115	12.0	1/2	58	910#
5010-SC	4 Sliding/3 Swing	33.5" x 120" x 52"	115	12.0	3/4	73	1090#
<b>44" H</b>							
4-Z-SC	2 Sliding/1 Swing	35.5" x 46" x 42.25"	115	8.0	1/4	23	365#
6-Z-SC	2 Sliding/2 Swing	35.5" x 70" x 42.25"	115	10.0	1/3	34	680#
8-Z-SC	2 Sliding/2 Swing	35.5" x 94" x 42.25"	115	10.0	1/2	46	815#
10-Z-SC	4 Sliding/3 Swing	35.5" x 118" x 42.25"	115	12.0	1/2	58	940#

### Fogel USA

831 Easy Cayuga St • Philadelphia, PA 19124 • 1-800-344-8222 • 1-215-464-6800  
 Fax: 1-215-969-4890 • Email: sales@fogelusa.com • www.fogelusa.com

# Display Cases – 5000 Series



## Technical Data

Model #	5004-SC	5006-SC	5008-SC	5010-SC
<b>Outside Dimensions</b>				
Depth	35.5"	35.5"	35.5"	35.5"
Length	48"	72"	96"	120"
Height	52"	52"	52"	52"
Door Size	16.25" x 21.5" 20.25" x 19.25"	28.75" x 21.5" 20.25" x 19.25"	40.75" x 21.5" 28.5"x19.25"	25.75" x 21.5" 28.5" x 19.25" 20.25" x 19.25"
Door Type	2 sliding 1 swing	2 sliding 2 swing	2 sliding 2 swing	4 siding 3 swing
<b>Inside Dimensions</b>				
Depth	26.5"	26.5"	26.5"	26.5"
Length	42.38"	66.38"	90.38"	114.38"
Height	46"	46"	46"	46"
Shelf Size	21.5" x 27.06"	20.25" x 27.06"	29.5" x 27.06"	28" x 27.06"
# of Shelves	2	3	3	4
Capacity: Cubic Foot	29	44	58	73
<b>Specifications</b>				
Operating Temperature	32°F-39°F	32°F-39°F	32°F-39°F	32°F-39°F
Refrigerant	R-134a	R-134a	R-134a	R-134a
Compressor Size HP	1/3	1/2	1/2	3/4
Penn Pressure control setting at 75° at 55%	Cut in 40 Cut out 15	Cut in 40 Cut out 15	Cut in 40 Cut out 15	Cut in 40 Cut out 15
Ranco Pressure control setting at 75° at 55%	Cut in 35 Cut out 25	Cut in 35 Cut out 25	Cut in 35 Cut out 25	Cut in 35 Cut out 25
Defrost per day (24hours)	2@2hrs	2@2hrs	2@2hrs	2@2hrs
Voltage	115	115	115	115
Amperage	8.0	9.0	12.0	12.0
Cord and Plug	yes	yes	yes	yes
<b>Shipping Dimensions</b>				
Depth	40"	40"	40"	40"
Length	52"	76"	100"	124"
Height	55.75"	55.75"	55.75"	55.75"
Gross Weight lbs.	421	596	718	940#
Cubic feet	67	98	129	160ft <sup>3</sup>

- Cases are designed to operate at 75° Fahrenheit and 55% relative humidity.
- Cases are equipped with drains; check your local building codes for connection requirement.
- Specification subject to change without notice.





# Display Cases – 5000 Series

Technical Data - Side View - Plan View

## 5004-SC and 5006-SC

Side View - Plan View

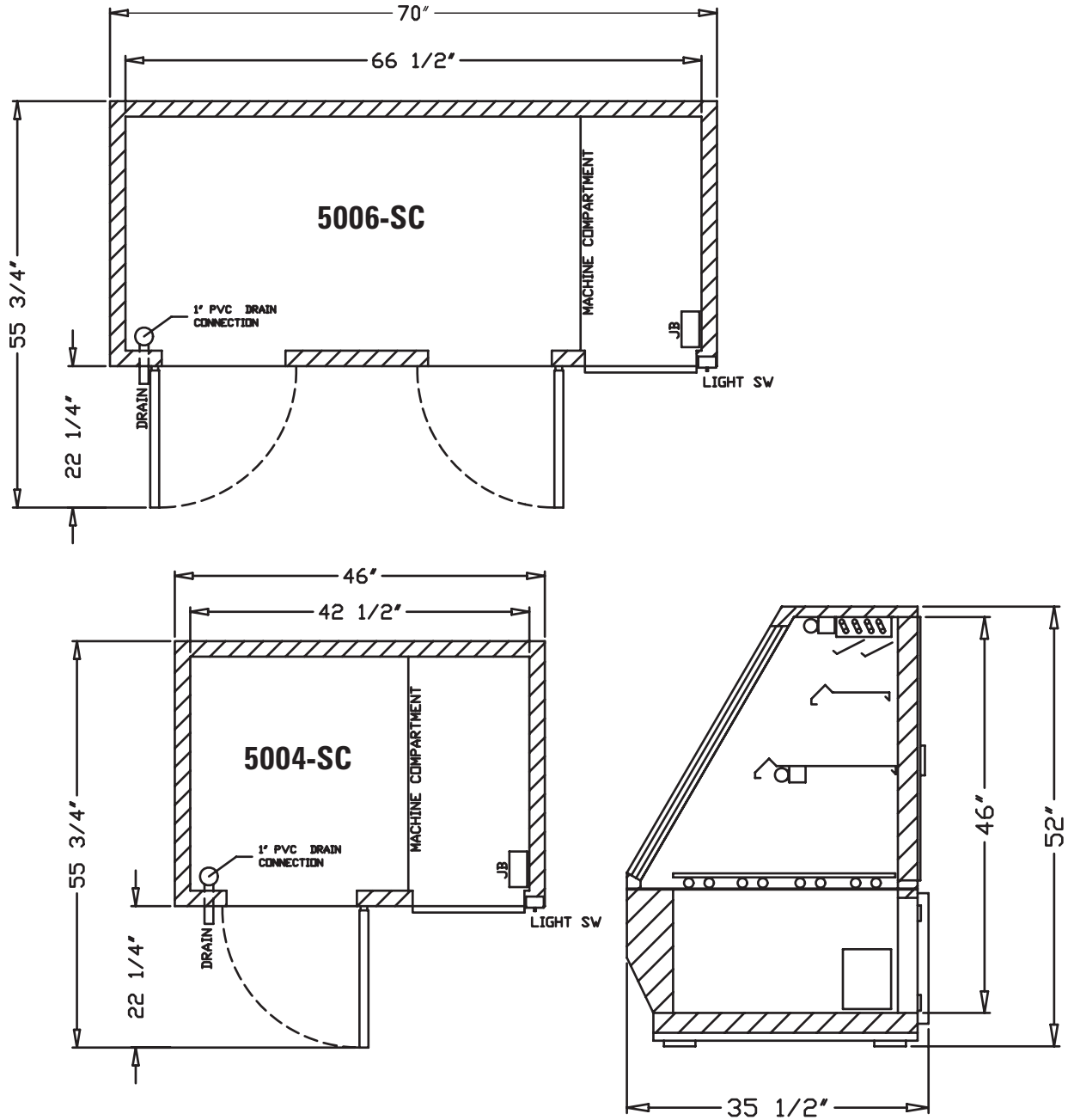

• Specification subject to change without notice.

### FOGEL GROUP USA, LLC

831 E Cayuga Street, Philadelphia, PA 19124 USA • (215) 464-6800 • 1-800-344-8222  
Fax (215) 969-4890 • E-Mail: sales@fogelusa.com • www.fogelusa.com





### 5008-SC and 5010-SC

#### Side View - Plan View

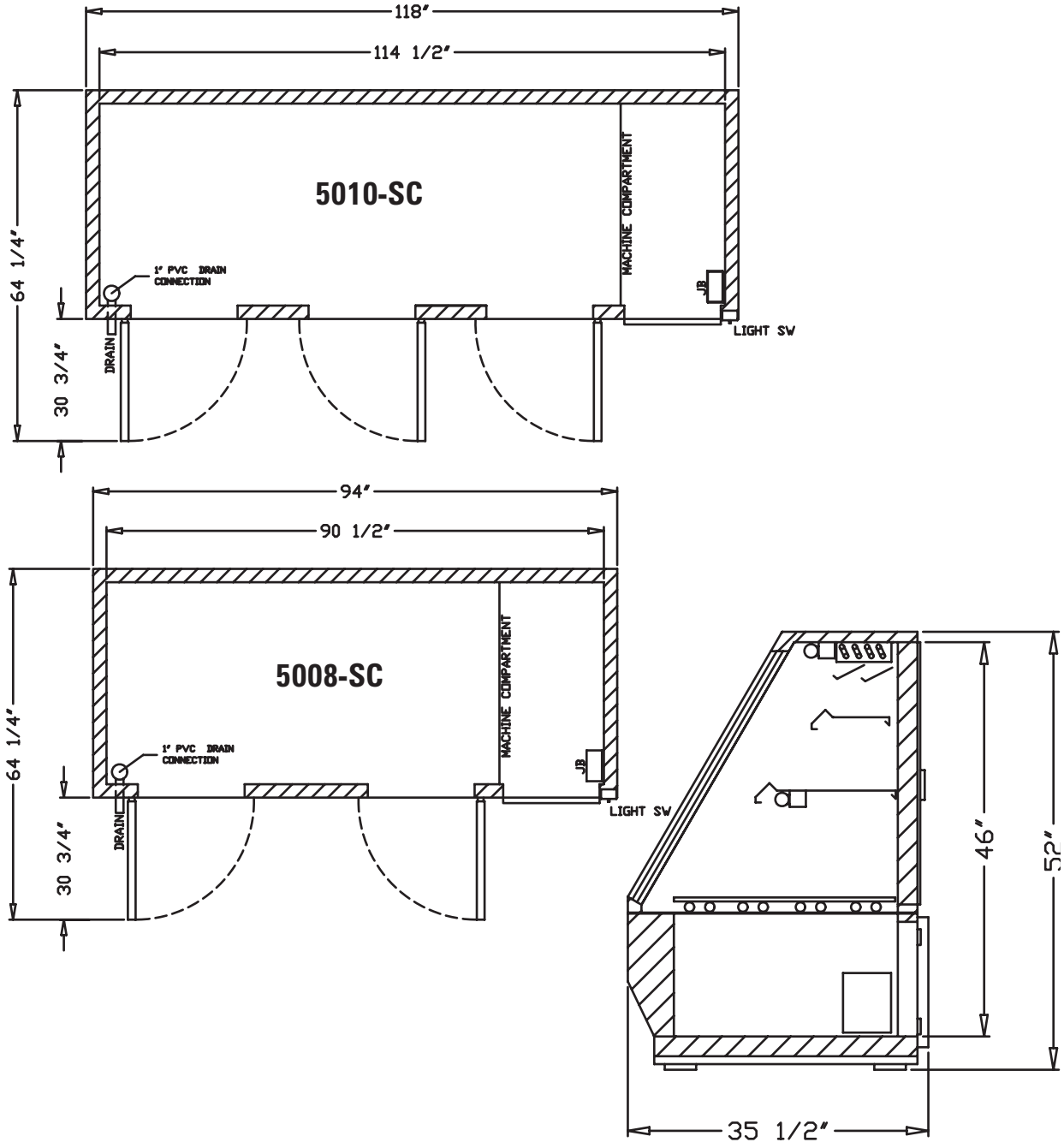

• Specification subject to change without notice.

#### FOGEL GROUP USA, LLC

831 E Cayuga Street, Philadelphia, PA 19124 USA • (215) 464-6800 • 1-800-344-8222  
Fax (215) 969-4890 • E-Mail: sales@fogelusa.com • www.fogelusa.com



# Display Cases – Zephyr Series – 44" H



## Technical Data

Model #	4-Z-SC	6-Z-SC	8-Z-SC	10-Z-SC
<b>Outside Dimensions</b>				
Depth	35.5"	35.5"	35.5"	35.5"
Length	46"	70"	94"	118"
Height	42.25"	42.25"	42.25"	42.25"
Door Size	16.5" x 14.5" 20.25" x 19.25"	28.75" x 14.5" 20.25" x 19.25"	40.75" x 14.5" 28.5" x 19.25"	25.75" x 21.5" 28.5" x 19.25" 20.25" x 19.25"
Door Type	2 sliding 1 swing	2 sliding 2 swing	2 sliding 2 swing	4 sliding 3 swing
<b>Inside Dimensions</b>				
Depth	26.5"	26.5"	26.5"	26.5"
Length	42.38"	66.538"	90.5"	114.38"
Height	37"	37"	37"	37"
Shelf Size	21.5" x 27.06"	20.25" x 27.06"	29.5" x 27.06"	28" x 27.06"
# of Shelves	2	3	3	4
Capacity: Cubic Foot	23	34	46	58
<b>Specifications</b>				
Operating Temperature	32°F-39°F	32°F-39°F	32°F-39°F	32°F-39°F
Refrigerant	R-134a	R-134a	R-134a	R-134a
Compressor Size HP	1/4	1/3	1/2	1/2
Penn Pressure control setting at 75° at 55%	Cut in 40 Cut out 15	Cut in 40 Cut out 15	Cut in 40 Cut out 15	Cut in 40 Cut out 15
Ranco Pressure control setting at 75° at 55%	Cut in 35 Cut out 25	Cut in 35 Cut out 25	Cut in 35 Cut out 25	Cut in 35 Cut out 25
Defrost per day (24hours)	2@2hrs	2@2hrs	2@2hrs	2@2hrs
Voltage	115	115	115	115
Amperage	8.0	10.0	10.0	12.0
Cord and Plug	yes	yes	yes	yes
<b>Shipping Dimensions</b>				
Depth	40"	40"	40"	40"
Length	52"	76"	100"	124"
Height	46.5"	46.5"	46.5"	46.5"
Gross Weight lbs.	365	680	815	940#
Cubic feet	56	82	108	133ft <sup>3</sup>

- Cases are designed to operate at 75° Fahrenheit and 55% relative humidity.
- Cases are equipped with drains; check your local building codes for connection requirement.
- Specification subject to change without notice.





# Display Cases – Zephyr Series – 44" H

Technical Data - Side View - Plan View

## 4-Z-SC and 6-Z-SC Side View - Plan View

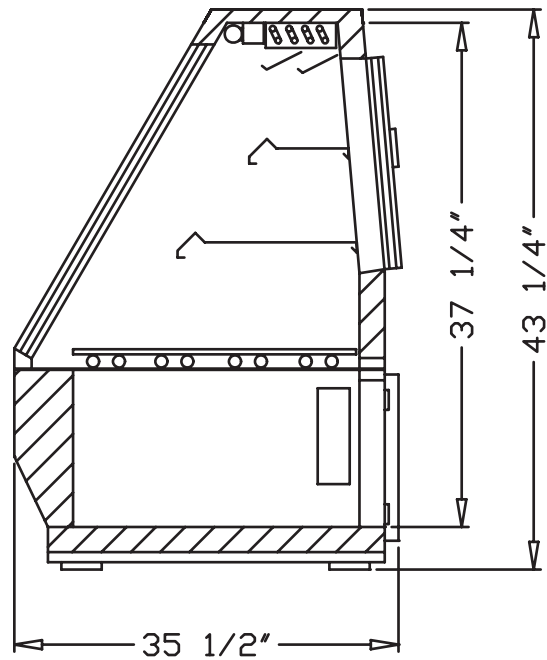
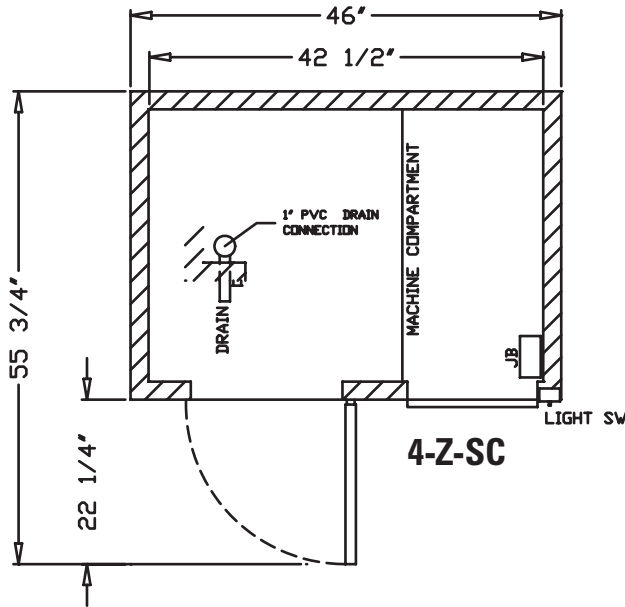
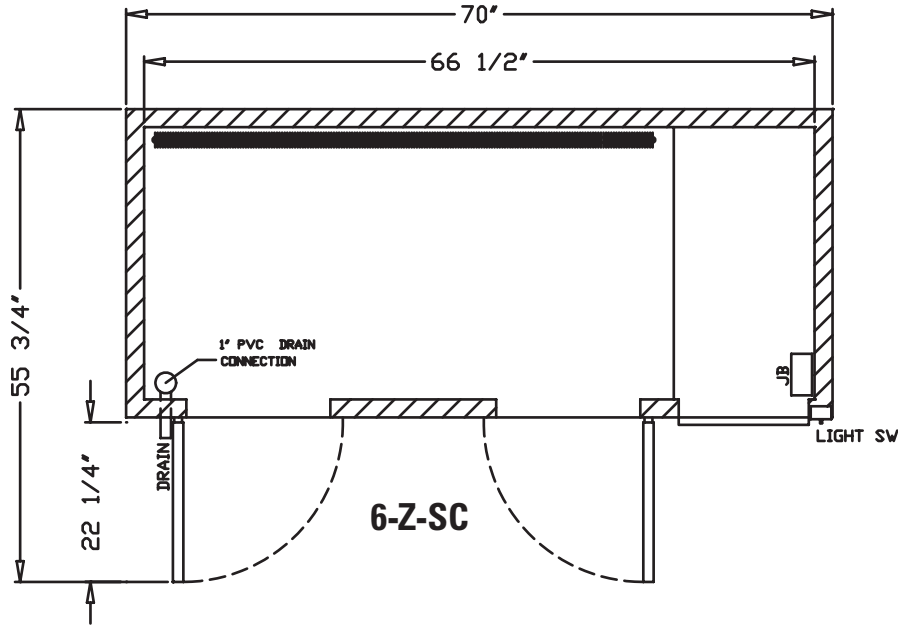

• Specification subject to change without notice.

### FOGEL GROUP USA, LLC

831 E Cayuga Street, Philadelphia, PA 19124 USA • (215) 464-6800 • 1-800-344-8222  
Fax (215) 969-4890 • E-Mail: sales@fogelusa.com • www.fogelusa.com





# Display Cases – Zephyr Series – 44" H

Technical Data - Side View - Plan View

## 8-Z-SC and 10-Z-SC

Side View - Plan View

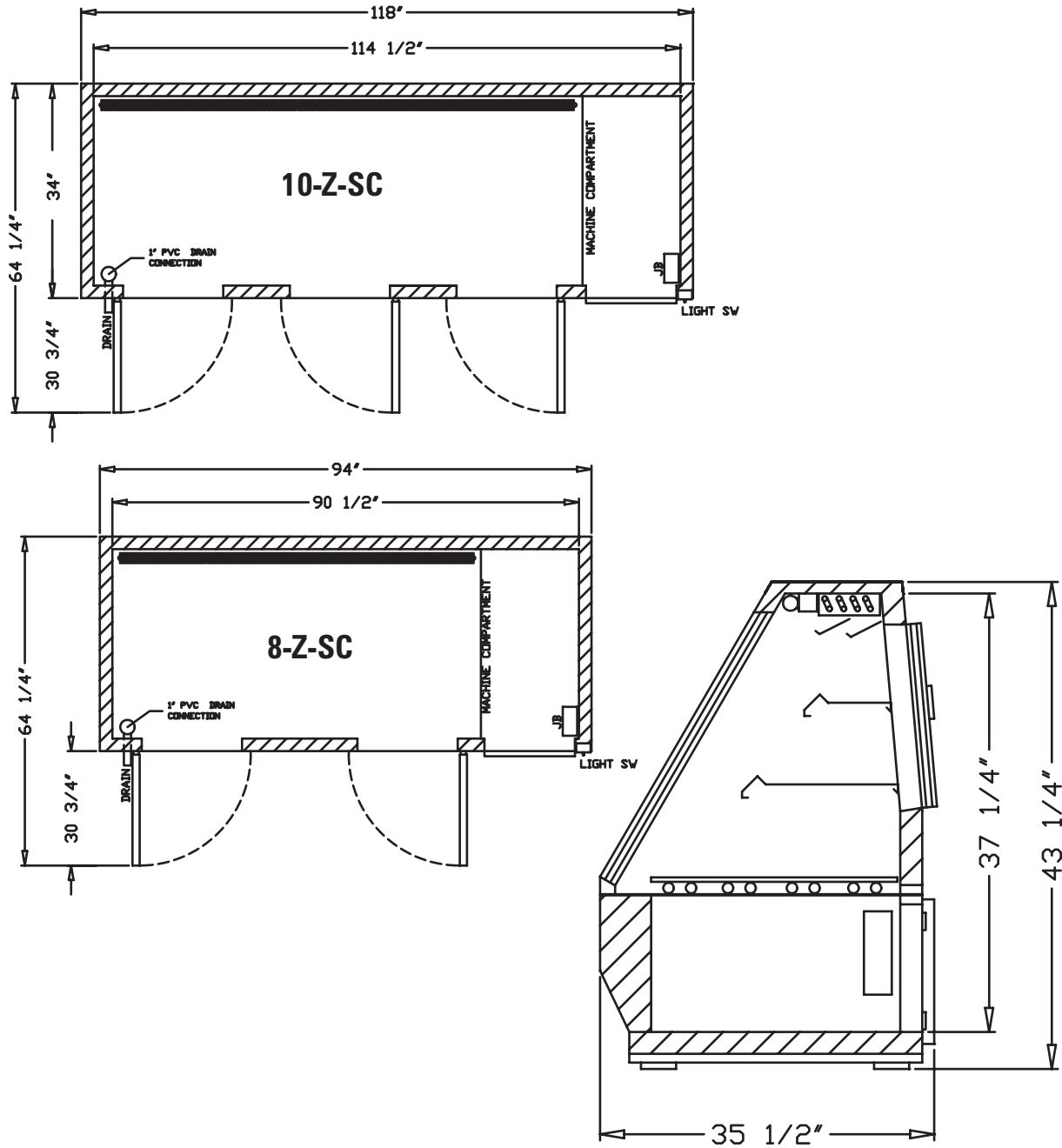

• Specification subject to change without notice.

### FOGEL GROUP USA, LLC

831 E Cayuga Street, Philadelphia, PA 19124 USA • (215) 464-6800 • 1-800-344-8222  
Fax (215) 969-4890 • E-Mail: sales@fogelusa.com • www.fogelusa.com

