



Ice Merchandisers

- Exterior cabinet made of white vinyl clad steel
- Custom front trim enhances cabinet appearance, Sturdy, stainless steel top
- Hinged door with chrome plated hardware, seals magnetically
- Reinforced, 16 gauge galvanized steel base
- Door locks furnished standard
- Strong body with thick walls, injected with CFC free polyurethane foam
- Heavy duty galvanized steel interior with air distribution channels
- High capacity blower cooled refrigeration system with automatic defrost
- Forced-air evaporator for quick temperature pull-down
- Forced-air condenser made of copper and aluminum, resistant to rust and saline environments

Model No.	Description	Size D x L x H	Voltage	Amps	HP	Cubic Feet	Est. Ship Wt
ICB-1	1 Solid Door	36.25" x 56" x 75.75"	115	10.0	1/3	47	415#
ICB-1-GL	1 Glass Doors	36.25" x 56" x 75.75"	115	12.0	1/2	47	437#
ICB-2	2 Door/2 Shelves	36.25" x 76" x 75.75"	115	12.0	1/2	60	425#
ICB-2-GL	2 Glass Doors/2 Shelves	36.25" x 76" x 75.75"	115	12.0	1/2	60	457#
CR-23-ICE-US	1 Door/4 Shelves	29.5" x 30" x 78"	115	7.7	1/3	23	340#

Fogel USA



Technical Data

Model #	ICB-1	ICB-2	ICB-1-GL	ICB-2-GL	CR-23-ICE-US
Outside Dimensions					
Depth	36.25"	36.25"	36.25"	36.25 "	29.5"
Length	55.5"	76.25	55.5	76.25	30"
Height	75.75"	75.75"	75.75"	75.75	78"
Door Size					30"x51.75"
Door Type	1 swing	2 swing	1 swing	2 swing	1 swing
Inside Dimensions					
Depth	30"	30"	30"	30"	61.25"
Length	51"	72"	51"	72"	25.25"
Height	55.5"	55.5"	55.5"	55.5"	61.25
# of 8lb bags	125	200	125	200	
# of Shelves	0	2	0	2	4
Capacity: Cubic Foot	47	60	47	60	23
Specifications					
Operating Temperature	23°F-30°F	23°F-30°F	23°F-30°F	23°F-30°F	23°F-30°F
Refrigerant	R-134a	R-134a	R-134a	R-134a	R-134a
Compressor Size HP	1/3	1/2	1/2	1/2	1/3
Defrost	3@30min	3@30min	3@30min	3@30min	3@30min
Voltage	115	115	115	115	115
Amperage	10.0	12.0	12.0	12.0	7.7
Cord and Plug	yes	yes	yes	yes	yes
Shipping Dimensions					
Depth	39.25"	39.25"	39.25"	39.25"	31.875"
Length	59.25"	80"	59.25"	80"	32.375"
Height	79"	79"	79"	79"	81.75"
Gross Weight lbs.	415	437	425	457	340
Cubic feet	106	144	106	144	48

- Specification subject to change without notice.





ICB-1 and ICB-2 Side View - Plan View

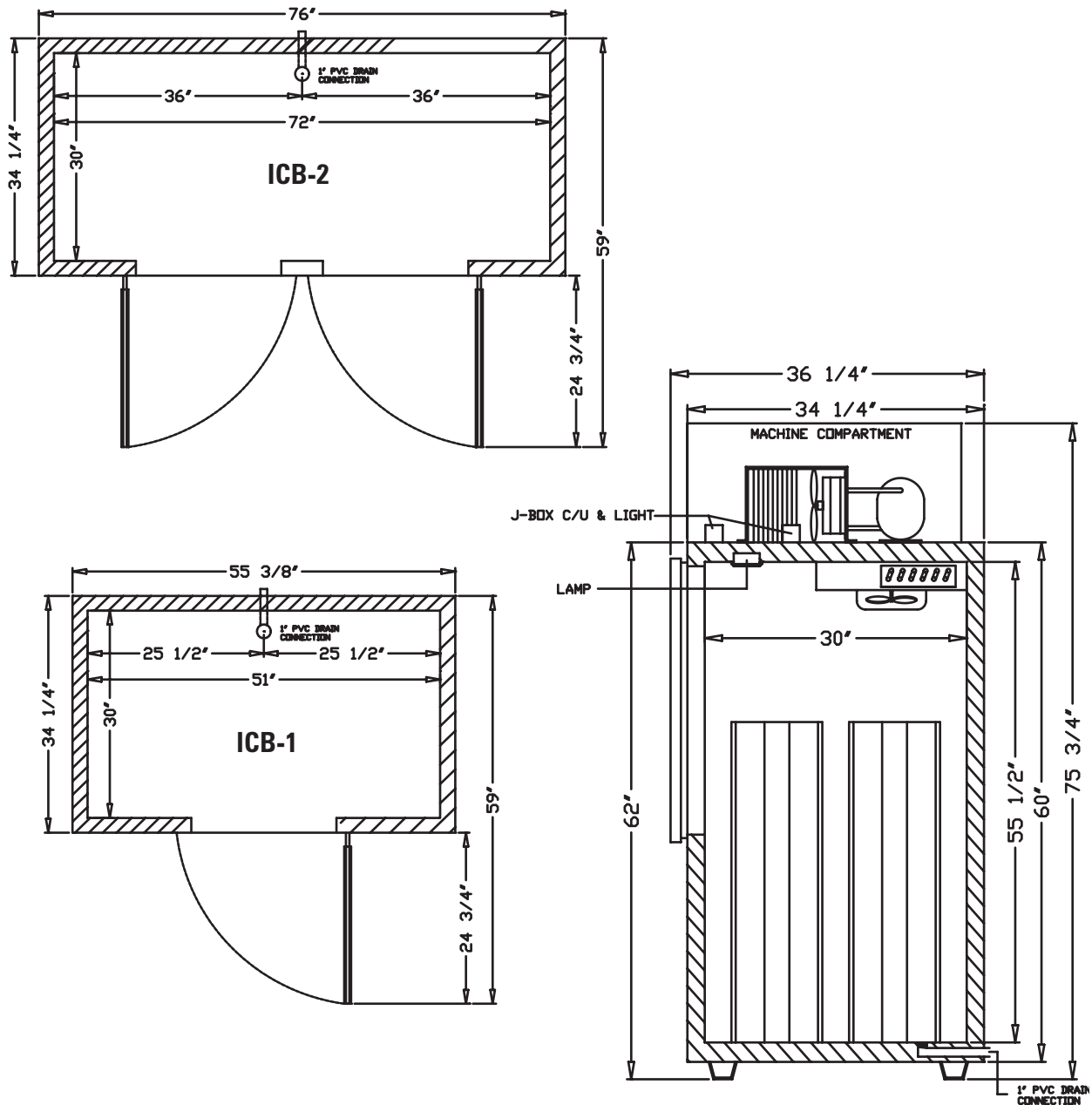

• Specification subject to change without notice.

FOGEL GROUP USA, LLC

831 E Cayuga Street, Philadelphia, PA 19124 USA • (215) 464-6800 • 1-800-344-8222
Fax (215) 969-4890 • E-Mail: sales@fogelusa.com • www.fogelusa.com





ICB-1-GL and ICB-2-GL
Side View - Plan View

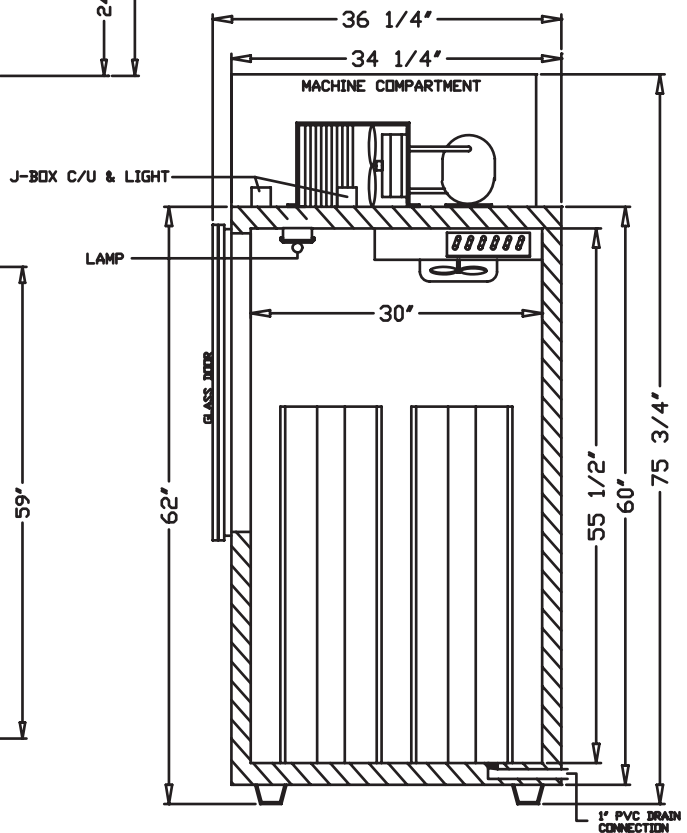
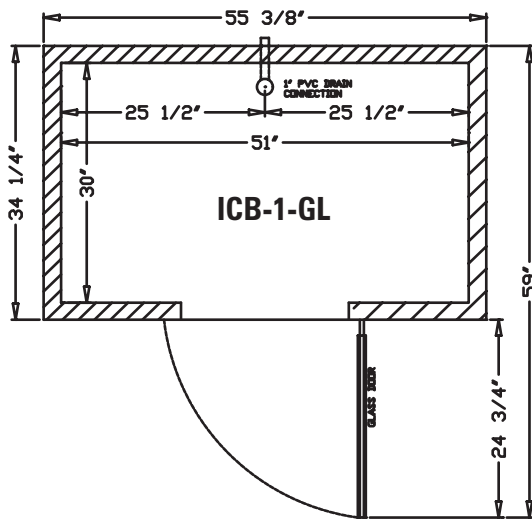
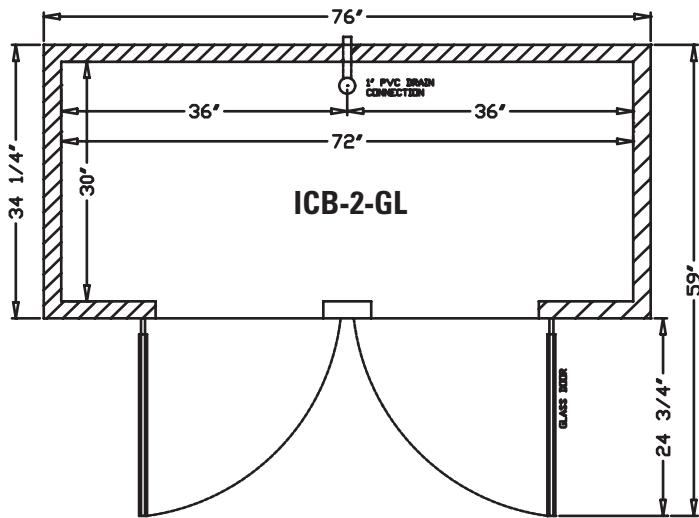

• Specification subject to change without notice.

FOGEL GROUP USA, LLC

831 E Cayuga Street, Philadelphia, PA 19124 USA • (215) 464-6800 • 1-800-344-8222
Fax (215) 969-4890 • E-Mail: sales@fogelusa.com • www.fogelusa.com





CR-23-ICE-US
Side View - Plan View

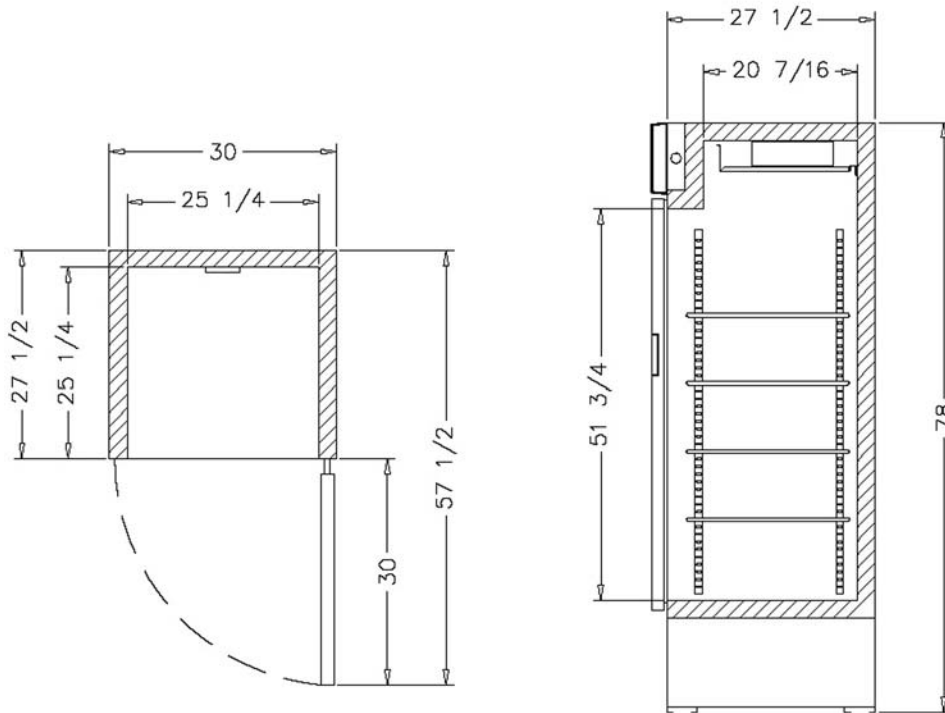

• Specification subject to change without notice.

FOGEL GROUP USA, LLC

831 E Cayuga Street, Philadelphia, PA 19124 USA • (215) 464-6800 • 1-800-344-8222
Fax (215) 969-4890 • E-Mail: sales@fogelusa.com • www.fogelusa.com

