

Sliding Glass Door

- Interior and exterior constructed of heavy-duty white coated steel
- CFC free foamed-in-place polyurethane insulation
- Stainless steel floor
- Recessed door handle, Sliding doors w/automatic return
- Heavy duty shelves with clips
- Robust body with 2-1/4", thick walls, injected with CFC-free polyurethane
- Double pane tempered glass door, for highly humid conditions
- Attractive PVC frame with 100% sealing gasket
- UL Classified to ANSI/NSF 7
- Forced air evaporator for quick temperature "Pull Down"
- Heavy duty condensing unit with R-134a refrigerant, located in front bottom for easy access maintenance
- Illuminated top header sign except for AB-4-G



Model No.	Description	Size DxLxH	Voltage	Amps	HP	Cubic Feet	Est. Ship Wt
CR-35-PC-US	2 Door/8 Shelves	29.5" x 43.5x 78"	115	7.9	1/3	35	420#
AB-4-G	2 Door/6 Shelves	29.5 x 46.5" x 72.5"	115	12.0	1/2	35	405#
VR-45-SD-US	2 Door/8 Shelves	29.5" x 51" x 78.25"	115	10.7	1/2	45	470#
CR-67-PC-US	3 Door/12 Shelves	29.5" x 76.75" x 78"	115	12.0	3/4	67	805#

Fogel USA

Glass Doors, Sliding–Bottom Mounts



Technical Data

Model #	VR-35-SD-US	VR-45-SD	CR-67-PC-US	AB-4-G
Outside Dimensions				
Depth	29.5"	29.5"	29.5"	29.5"
Length	43.5"	54"	76.75"	46.5"
Height	78"	78"	78"	72.5"
Door Size	48.875"x19.125"	48.875"x24.375"	48.875"x24.375"	20.75" x 52"
Door Type	2 sliding	2 sliding	3 sliding	2 Sliding
Inside Dimensions				
Depth	27.25"	27.25"	27.25"	37.38"
Length	38.75"	49.25"	72"	42"
Height	60.38"	60.38"	60.38"	54.63"
Shelf Size	(4) 19.812"x23" (4) 17.812"x23"	(4) 25.188"x23" (4) 23.188"x23"	(8) 23"x24" (4) 25"x23.75"	20.25" x 23.625"
# of Shelves	8	8	12	6
Capacity: Cubic Foot	35	45	67	35
Specifications				
Operating Temperature	32°F-39°F	32°F-39°F	32°F-39°F	32°F-39°F
Refrigerant	R-134a	R-134a	R-134a	R-134a
Compressor Size HP	1/3	1/2	3/4	1/2
Voltage	115	115	115	115
Amperage	7.9	10.9	12	12
Cord and Plug	yes	yes	ye	yess
Shipping Dimensions				
Depth	31.875"	31.875"	31.875"	32"
Length	45.875"	56.375"	79.5"	48"
Height	81.75"	81.75"	81.75"	75.5"
Gross Weight lbs.	420	470	805	405#
Cubic feet	67	83	115	67

- Cases are designed to operate at 75° Fahrenheit and 55% relative humidity.
- Specification subject to change without notice.





Glass Doors, Sliding-Bottom Mounts

Technical Data - Side View - Plan View

CR-35-PC-US, VR-45-SD and CR-67-PC-US

Side View - Plan View

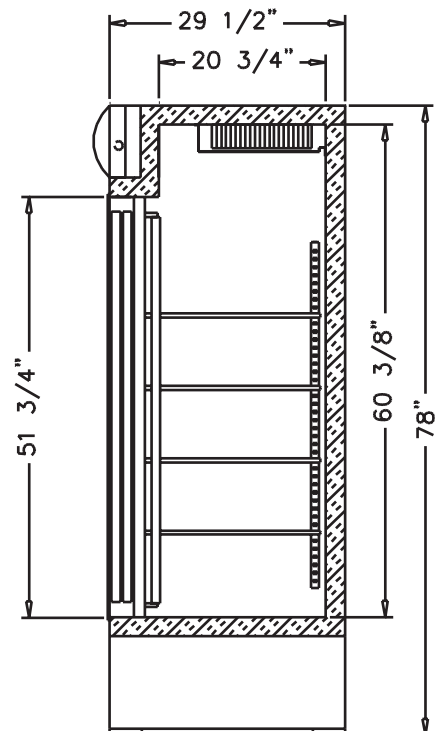
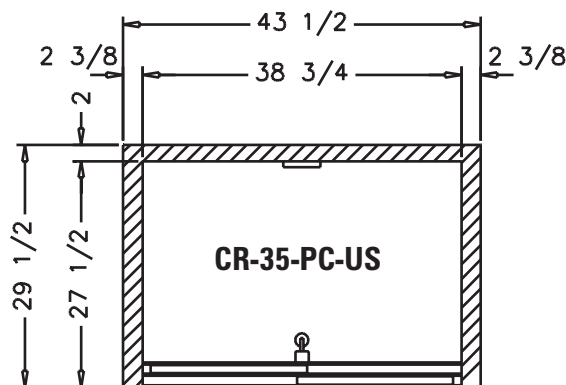
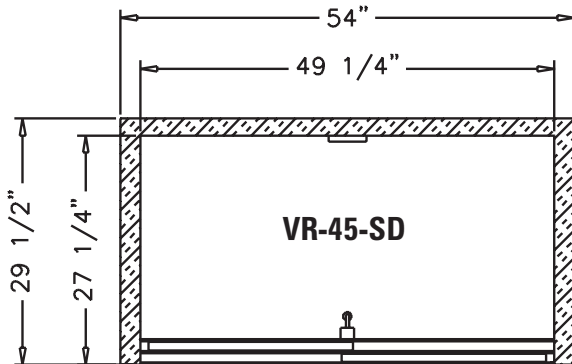
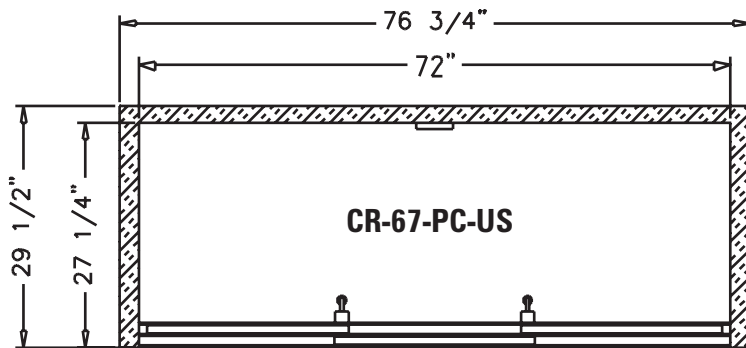

• Specification subject to change without notice.

FOGEL GROUP USA, LLC

831 E Cayuga Street, Philadelphia, PA 19124 USA • (215) 464-6800 • 1-800-344-8222
Fax (215) 969-4890 • E-Mail: sales@fogelusa.com • www.fogelusa.com





Sliding Glass Door Merchandiser

Technical Data - Side View - Plan View

AB-4-G Side View - Plan View

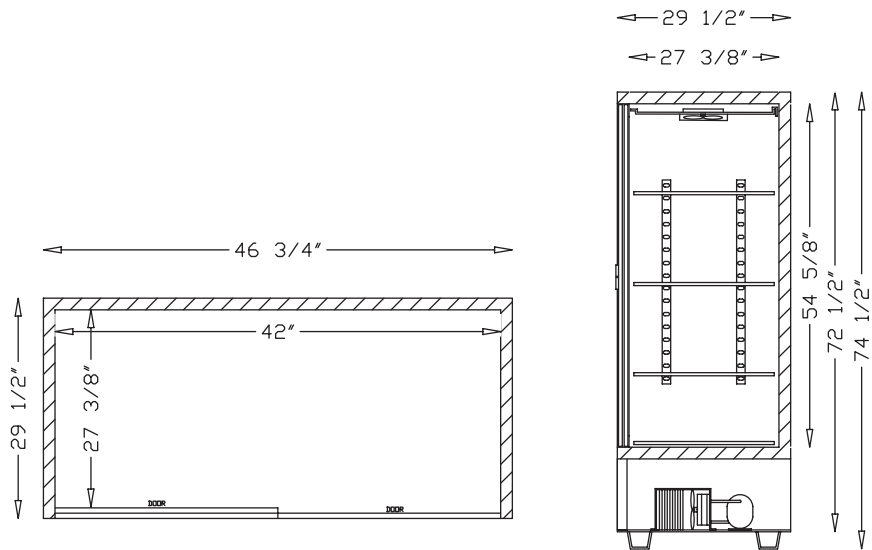

TOP VIEW

SIDE VIEW

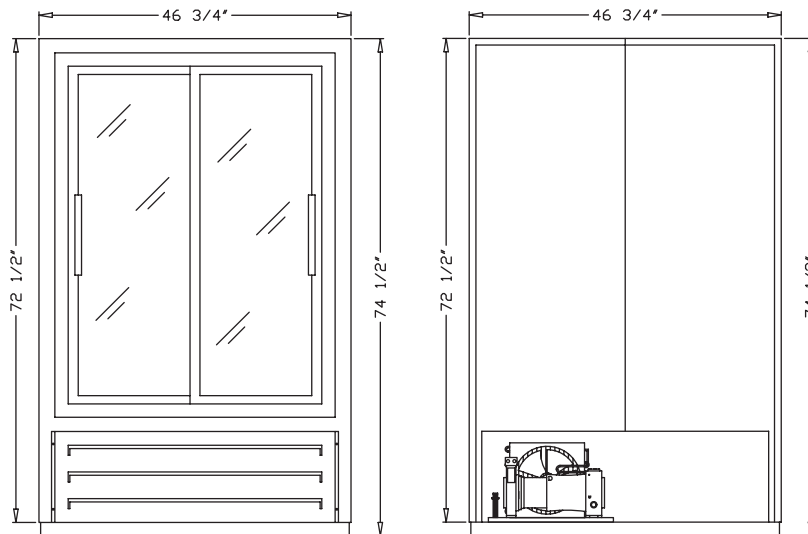

FRONT VIEW

REAR VIEW

• Specification subject to change without notice.

FOGEL GROUP USA, LLC

831 E Cayuga Street, Philadelphia, PA 19124 USA • (215) 464-6800 • 1-800-344-8222
Fax (215) 969-4890 • E-Mail: sales@fogelusa.com • www.fogelusa.com

