

www.fogelusa.com



Bottle Coolers

- Sturdy, stainless steel top, glass stop and lids
- Bottle opener and cap catcher – BC-95DBST on both front corners
- Rubber pull handle for easy sliding of lids
- Strong body with thick walls, injected with CFC free polyurethane foam
- Exterior cabinet and lining made of galvanized, pre-painted steel, with baked polyester paint
- Interior lining made of acrylic-coated galvanized steel for extra corrosion resistance
- Reinforced, adjustable, heavy-duty dividers
- Fully sealed reinforced, 16 gauge galvanized steel base to prevent dirt accumulation underneath the unit
- UL Classified to ANSI/NSF 7
- Forced-air evaporator for quick temperature pull-down, made of copper and aluminum, resistant to rust and saline environments
- Heavy-duty R-134a condensing unit with easy access for maintenance



Model No.	Description	Size D x L x H	Voltage	Amps	HP	Cubic Feet	Est. Ship Wt
BC-50-DBST	2 Door	27.5" x 52.25" x 34.25"	115	6.7	1/4	14	293#
BC-65-DBST	2 Door	27.5" x 66.75" x 34.25"	115	8.7	1/3	19	344#
BC-95-DBST	3 Door	27.5" x 98" x 34.25"	115	8.7	1/3	30	465#

Fogel USA

831 Easy Cayuga St • Philadelphia, PA 19124 • 1-800-344-8222 • 1-215-464-6800
Fax: 1-215-969-4890 • Email: sales@fogelusa.com • www.fogelusa.com

Bottle Coolers—Sliding Doors



Technical Data

Model #	BC-50-DBST	BC-65-DBST	BC-95-DBST
Outside Dimensions			
Depth	27.5"	27.5"	27.5"
Length	52.25"	66.75"	97.75"
Height	34.25"	34.25"	34.25"
Door Size	26.687"L x 12.75"W	29.75"L x 12.75"W	29.312"L x 12.75"W
Door Type	2 sliding	2 sliding	3 sliding
Inside Dimensions			
Depth	22.25"	22.25"	22.25"
Length	46.25"	60.75"	91.75"
Height	27.5"	27.5"	27.5"
# of Dividers	2	3	4
# of 12oz Bottles of Beer	396	528	900
Capacity: Cubic Foot	14	19	30
Specifications			
Operating Temperature	33°F-41°F	33°F-41°F	33°F-41°F
Refrigerant	R-134a	R-134a	R-134a
Compressor Size HP	1/4	1/3	1/3
Voltage	115	115	115
Amperage	6.7	8.7	8.7
Cord and Plug	yes	yes	yes
Shipping Dimensions			
Depth	30.25"	30.25"	30.25"
Length	55"	69.75"	101"
Height	40.5"	40.5"	40.5"
Gross Weight lbs.	293	344	465
Cubic feet	39	50	72

- Specification subject to change without notice.





Bottle Coolers—Sliding Doors

Technical Data - Side View - Plan View

BC-50-DBST, BC-65-DBST and BC-95-DBST Side View - Plan View

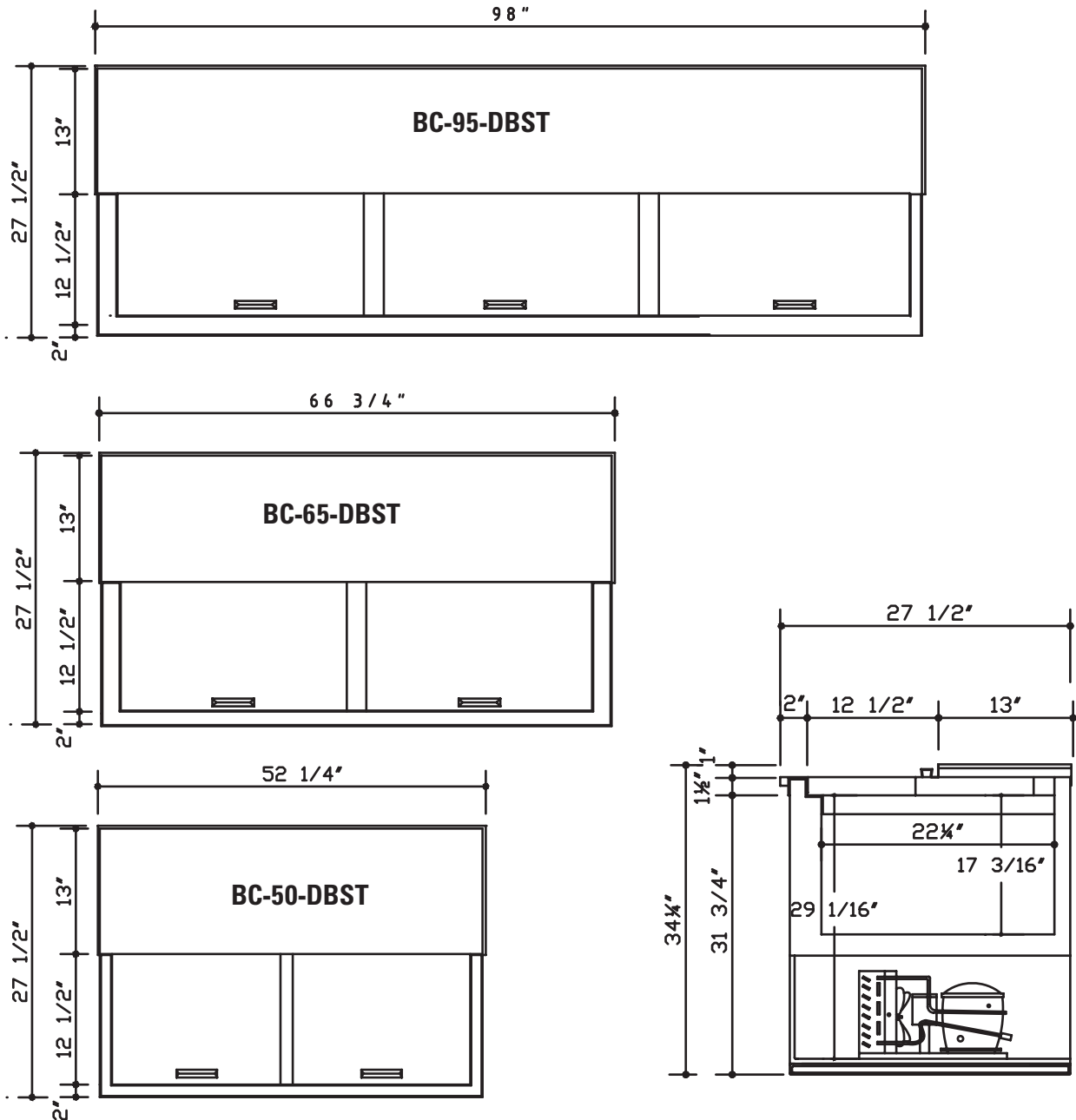

• Specification subject to change without notice.

FOGEL GROUP USA, LLC

831 E Cayuga Street, Philadelphia, PA 19124 USA • (215) 464-6800 • 1-800-344-8222
Fax (215) 969-4890 • E-Mail: sales@fogelusa.com • www.fogelusa.com

